

Ecostyle PCV Steel Panel Radiators



Type 21 (2 Panels, 1 Convector) Type 22 (2 Panels, 2 Convectors)

- Premium Designer Radiators
- White enameled finish for scratch & corrosion resistance
 - Provides both radiant and convective heat
- Well suited for standard efficiency and condensing boilers
 - Easy to sub-zone



QHT
INCORPORATED
The New Style of Warmth

comfort delivered by **PURMO**

Horizontal Panels Type 21 and Type 22 6 Pipe Connection Panels (1/2")

Product Code	Height (inch)	Length (inch)	Output (BTU/HR) @ 180°F x 68°F**	Output (BTU/HR) @ 140°F x 68°F**	Weight (lbs)	Water Content (gal)
PCV8 2421	8"	24"	1,346	781	17	.40
PCV8 3621		36"	2,022	1,173	27	.60
PCV8 4821		48"	2,698	1,565	35	.80
PCV8 5621		56"	3,147	1,825	41	.90
PCV8 7121		71"	4,046	2,347	52	1.2
PCV8 9221		92"	5,172	3,000	67	1.5
PCV08 12021		120"	6,742	3,910	94	2.0
PCV12 1622		12"	16"	1,705	1,031	18
PCV12 2422	24"		2,562	1,548	27	.53
PCV12 3222	32"		3,414	2,064	35	.71
PCV12 4022	40"		4,266	2,579	45	.90
PCV12 4822	48"		5,119	3,094	54	1.08
PCV12 5622	56"		5,971	3,610	62	1.27
PCV12 6422	64"		6,828	4,128	71	1.43
PCV16 1622	16"		16"	2,167	1,310	24
PCV16 2422		24"	3,254	1,967	37	.71
PCV16 3222		32"	4,337	2,622	49	.95
PCV16 4022		40"	5,421	3,277	60	1.19
PCV16 4822		48"	6,504	3,932	72	1.43
PCV16 5622		56"	7,587	4,586	84	1.66
PCV16 6422		64"	8,675	5,244	95	1.90
PCV16 7122		71"	9,758	5,899	107	2.11
PCV20 1622	20"	16"	2,610	1,578	30	.58
PCV20 2422		24"	3,916	2,367	45	.87
PCV20 3222		32"	5,221	3,156	61	1.14
PCV20 4022		40"	6,526	3,945	76	1.43
PCV20 4822		48"	7,831	4,734	90	1.72
PCV20 5622		56"	9,137	5,523	105	2.01
PCV206422		64"	10,442	6,312	120	2.30
PCV24 1622		24"	16"	3,037	1,836	37
PCV24 2422	24"		4,551	2,751	55	1.06
PCV24 3222	32"		6,069	3,669	73	1.40
PCV24 4022	40"		7,587	4,586	90	1.74
PCV24 4822	48"		9,106	5,504	109	2.09
PCV24 5622	56"		10,624	6,422	127	2.43
PCV24 6422	64"		12,138	7,337	144	2.80
PCV24 7122	71"		13,656	8,255	162	3.14
PCV36 1622	36"	16"	4,240	2,563	56	.95
PCV36 2422		24"	6,362	3,846	83	1.43
PCV36 3222		32"	8,480	5,126	110	1.90
PCV36 4022		40"	10,602	6,409	137	2.38
PCV36 4822		48"	12,724	7,691	165	2.85

**outputs based on water supply temperatures @ 20°Δ T x 68°F room temperature
All PCV Radiators: Test Pressure: 191 psi - Max Operating Pressure: 147 psi

NOTE: Other sizes are available per request, please contact for more options.



Actual Dimensions Type 21 & 22

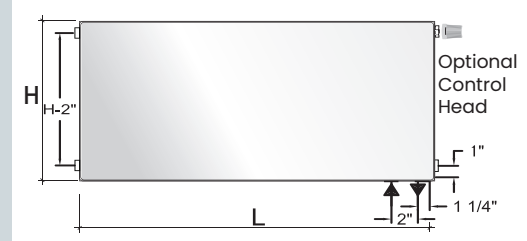

Type 21

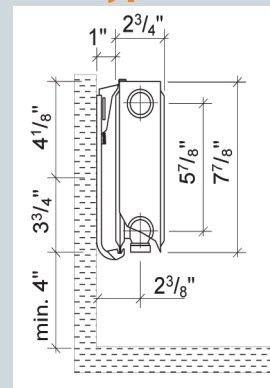

Type 22

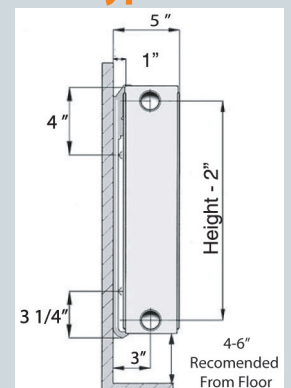

Type 21



Type 22



Standard Features

- Internal thermostatic valve body
- Contoured side panels and top grille
- Adjustable mounting brackets
- Installed: plugs and air vent



Now offering an extensive range of colors. Please contact QHT for details.



www.ecostyle.us 800-501-7697

www.purmoUSA.com

PURMO

05/03/2021